

These features determine the representation of the graphic.

When you select a graphic on the content pane, other graphics on the same content pane are dimmed, and only the selected graphic appears sharp as usual (see the following figure). The same happens, when you select a graphical comment in the [Comments pane](#).

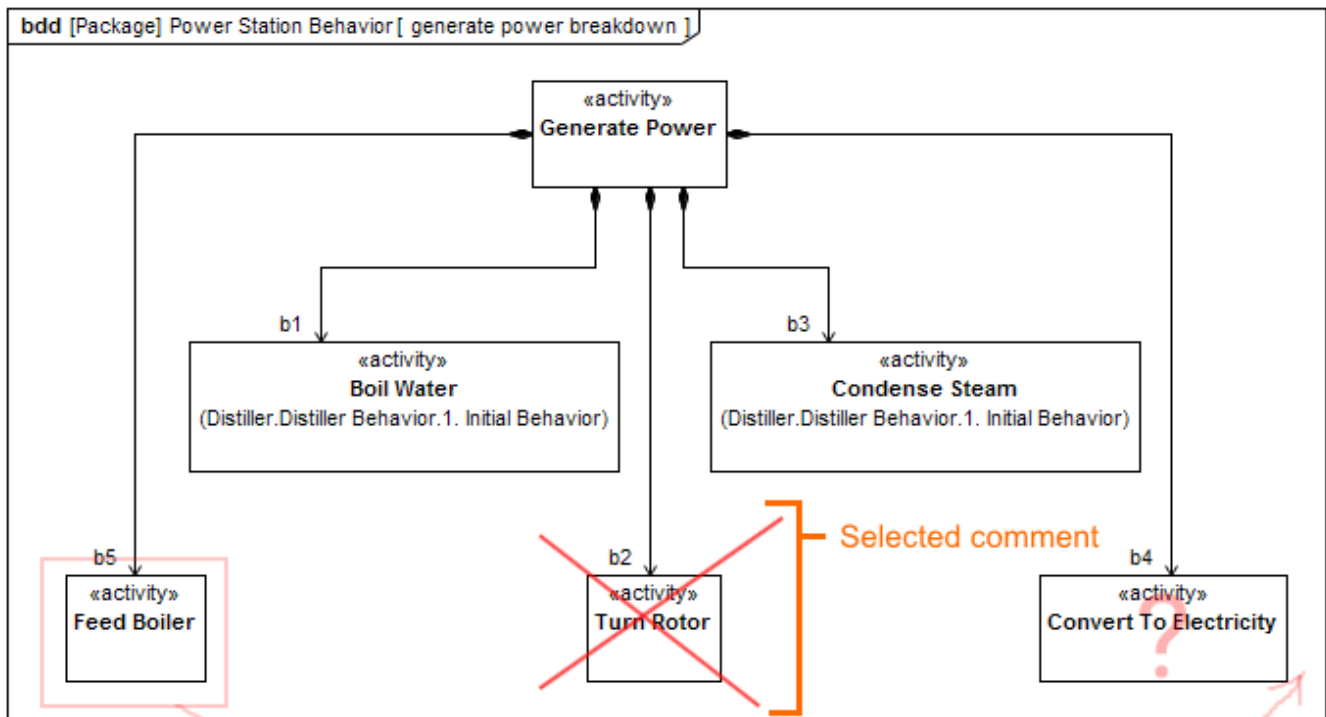

In contrast to colorful unresolved graphical comments, the resolved ones are represented in gray color, as you can see in the following figure.

Unresolved comment

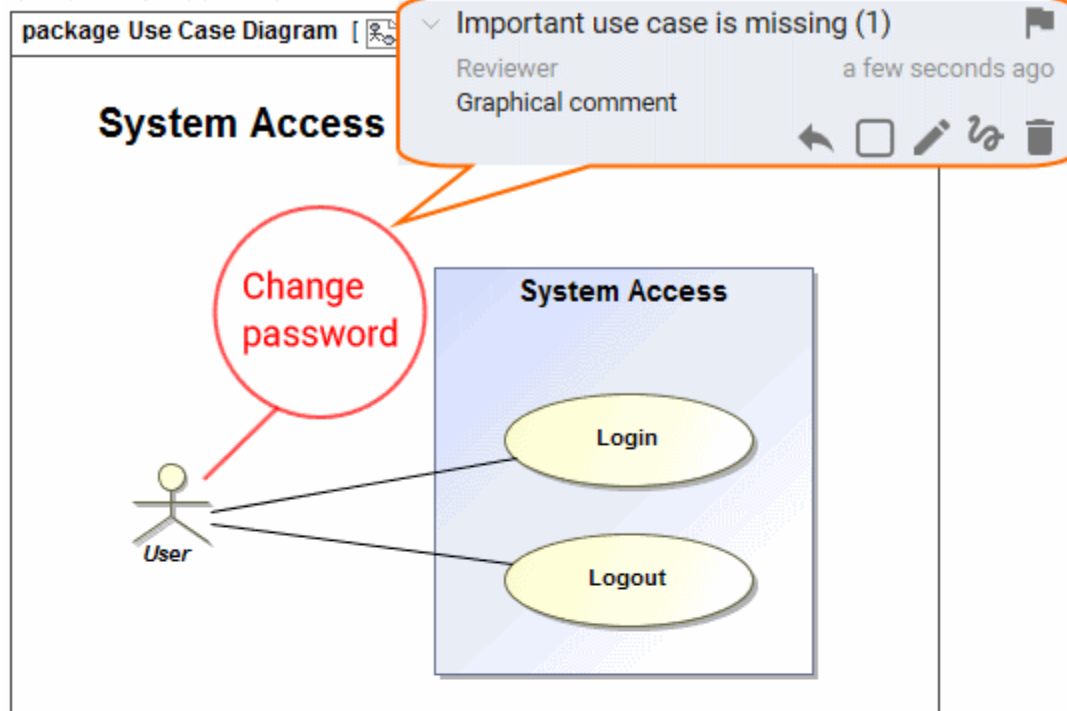

Resolved comment

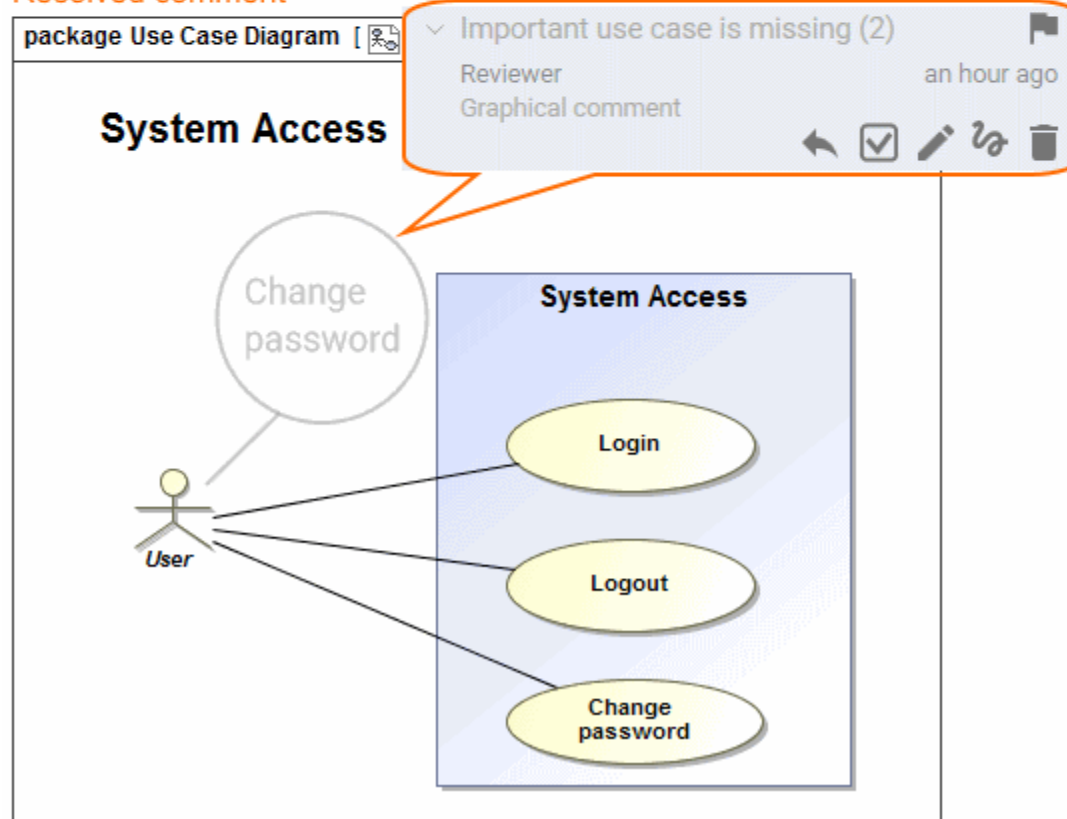

Navigation from hyperlinked symbols

Clicking a symbol that has a hyperlink to a diagram opens the menu from which you can choose to open either the content pane of the appropriate element or the one of the related diagram.

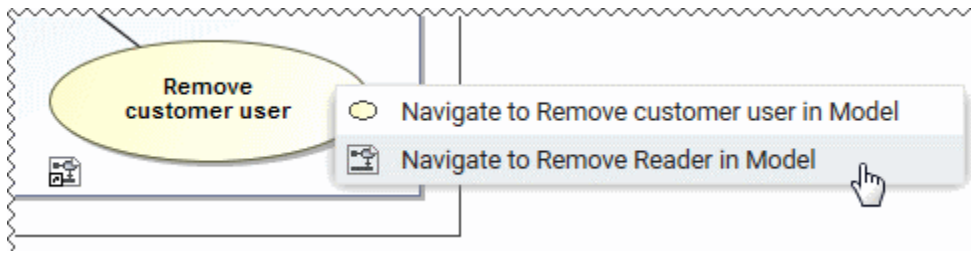

Opening items in Model Editor

You can easily open the reviewed item in your model editor, that is, MagicDraw, Cameo Systems Modeler, or other. Find the **Open in Model Editor** property on the content pane and click the item name displayed as the property value.

Related pages

- [Components of the published project portal](#)
 - [Navigation menu](#)
 - [Search](#)
 - [Navigation pane](#)
 - [Comments pane](#)
 - [Views and modes of a published project](#)